

DU PONT Hytrel®

Steel coated with thermoplastic polyester elastomer

Standard Discharge Elbow

45° Elbow Bend to Select Discharge Direction

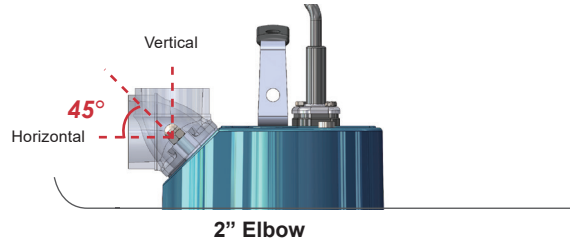

APPLICATIONS

- Site drainage, mining, tunneling, public works, floods.
- Cement industry, river intake, civil engineering projects.

FEATURES

- Compact & lightweight design.
- Puddle or residue drainage down to 3mm.
- 45° Elbow Bend to Select Discharge Direction
- Efficient circumferential cooling for continuous duty.

OPERATING CONDITIONS

Liquid temperature	0~40°C (32~104°F)
Submersible depth	10M
Frequency	50Hz
Pole	2 Pole
Motor type	Dry type
Insulation class	Class B
Protection	IP 68
Protector	Auto-Cut
Bearing	Ball type
Mechanical seal	Double mechanical seal
Impeller	Semi-open Impeller

MODEL DESCRIPTION

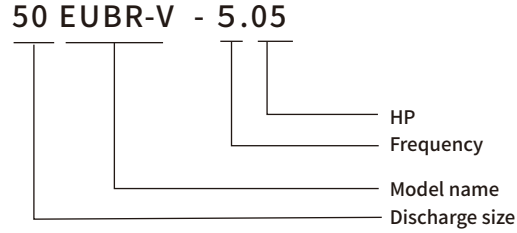

CURVES

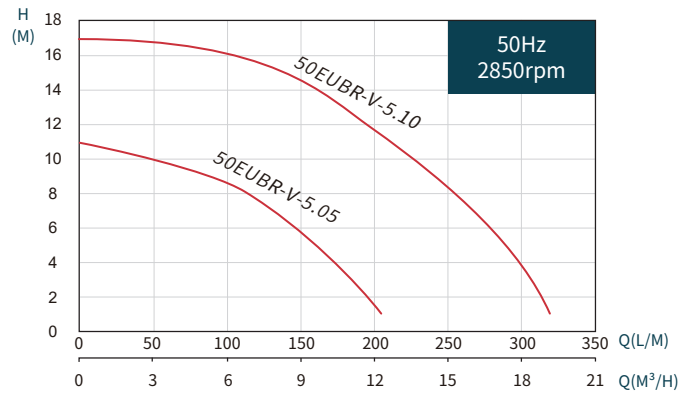

PERFORMANCE

MODEL	OUTPUT		DISCHARGE Inch	Q(lpm) Q(m³/h)	0	50	100	150	200	250	300
	HP	kW			0	3	6	9	12	15	18
50EUBR-V-5.05	0.5	0.37	2"	H(m)	11	10.1	8.6	5.8	1.6	-	-
50EUBR-V-5.10	1	0.75	2"		17	17	16.1	14.4	11.9	8.4	3.8

SPECIFICATIONS

Model	Output		Discharge Inch	F.L.A.		Rated		Maximum		Free passage mm	Weight(W/O Cable) kg
	HP	kW		1Ø 230V	3Ø 400V	Head m	Cap. lpm	Head m	Cap. lpm		
50EUBR-V-5.05	0.5	0.37	2"	3A	0.9A	8	115	11	205	2	12
50EUBR-V-5.10	1	0.75	2"	6A	1.9A	10	225	17	320	2	14.5

DIMENSIONS(mm)

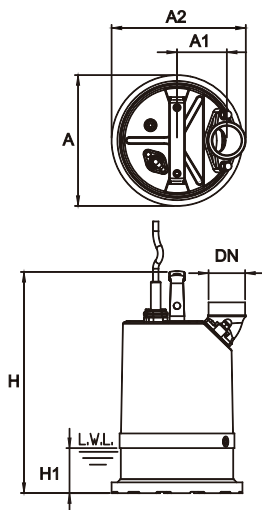

Type	A	A1	A2	H	H1	DN
50EUBR-V-5.05	214	82	220	347	52	2"
50EUBR-V-5.10	214	82	220	372	52	2"

PARTS AND MATERIALS LIST

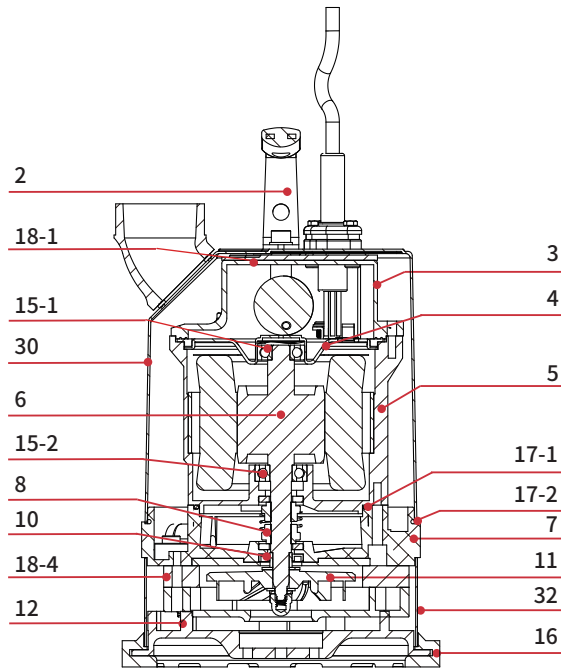

No.	Part	Material
2	Handle	Steel+NBR
3	Motor Cover	ADC12
4	Bracket	Steel
5	Motor Housing + Stator	ADC12+Steel
6	Shaft with Rotor	AISI 410
7	Oil Chamber	ADC12
8	Mechanical Seal	CA/CE+SIC/SIC
10	Lip Seal	NBR
11	Impeller	Hytrell
12	Pump Casing	EN-GJL-200
15-1	Upper Bearing	NTN/TPI
15-2	Lower Bearing	NTN/TPI
16	Strainer	NBR
17-1	O-ring	NBR
17-2	O-ring	NBR
18-1	Gasket	NBR
18-4	Volute Liner	NBR
30	Outer Housing	SPCC
32	Pump Housing Ring	AISI 304

TPI is a family brand of NTN group.