

**LIGHTWEIGHT SUBMERSIBLE
RESIDUE DEWATERING PUMP**

EUBR
EUBRS AISI 304
EUBRI AISI 316
SERIES 60HZ



Features

- High resistance to abrasive liquids
- Loss wax casting AISI 304 & AISI 316 for EUBRS and EUBRI
- Viton gasket, O-rings, and Lip seal for EUBRI (AISI 316)
- Compact & Lightweight design
- Puddle or residue drainage down to 3mm
- Efficient circumferential cooling for continuous duty

Applications

- Site drainage, mining, tunneling, public works, floods
- Cement industry, river intake, civil engineering projects
- Basement, parking lots, removing residue water (EUBR/EUBRS/EUBRI)
- Version "S" in AISI 304 and "I" in AISI 316 are suitable for light chemical liquids in drainage and general pumping applications

Data Chart

Type	Output		Discharge	F.L.A.			Rated		Maximum		Free Passage	Weight(W/O Cable)	
	HP	kW		1ø 230V	3ø 230V	3ø 460V	Head FT	Cap. GPM	Head FT	Cap. GPM		mm	1ø-kg
	0.5	0.37	2"	3.3A	2.2A	1.1A	26	30	36	56	2	12	12
	0.5	0.37	2"	3.3A	2.2A	1.1A	26	30	36	56	2	14.6(13.8)	14.6(13.8)
	1	0.75	2"	6A	4A	2A	46	40	65.5	75	2	14.5	14.5
	1	0.75	2"	6A	4A	2A	46	40	65.5	75	2	17.8(16.5)	17.8(16.5)

Specifications

Liquid Temperature	0~40°C (32~104°F)	
Submersible depth	10M	
Motor Part	Frequency	60Hz
	Pole	2 Pole
	Type	Dry Type
	Insulation	Class B
	Protection	IP 68
Pump Part	Protector	Auto-cut
	Bearing	Ball Type
	Mechanical seal	Double Mechanical Seal
	Impeller	Semi-open Impeller



KLIXON
1PH Protector
(Thermal)



KLIXON
1PH Protector
(optional)
(overheat & overload)

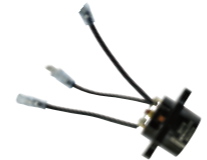

KLIXON
3PH Protector
(overheat, overload,
phase failure)



DU PONT Hytrel®
Steel coated with
thermoplastic
polyester elastomer



**Loss Wax Stainless
Steel AISI 304 & 316
EUBRS(I) Impeller**



**Viton gasket, O-rings,
and Lip seal
for EUBRI (AISI 316)**

KLIXON

KLIXON protector provides protection against overheating and stalled rotor conditions including:

- Plugging duty
- Stalling or failure to start
- Heavy overloads
- High ambient
- Ventilation failures

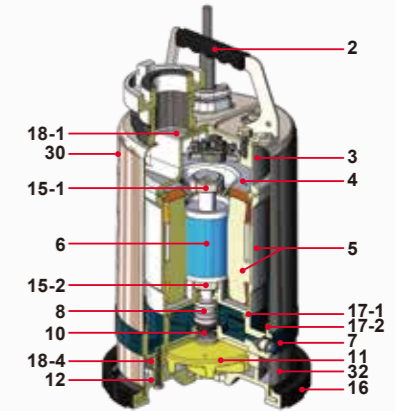

Parts and Material List

No.	Part	Material		
		EUBR	EUBRS	EUBRI
2	Handle	Steel+BUNA N	AISI 304+BUNA N	
3	Motor Cover	ADC12	AISI 304	
4	Bracket	Steel	ASTM A48 Class 30	
5	Motor Housing + Stator	ADC 12+Steel	AISI 304	
6	Shaft with Rotor	AISI 410	AISI 304	
7	Oil Chamber	ADC12	AISI 304	
8	Mechanical Seal	CA/CE+SIC/SIC		
10	Lip Seal	BUNA N	BUNA N	
11	Impeller	Hytrel	AISI 304	
12	Pump Casing	ASTM A48 Class 30	AISI 304	
15-1	Upper Bearing			
15-2	Lower Bearing			
16	Strainer	BUNA N	EPDM	
17-1	O-ring	BUNA N	BUNA N	
17-2	O-ring	BUNA N	BUNA N	
18-1	Gasket	BUNA N	EPDM	
18-4	Volute Liner	BUNA N	EPDM	
30	Outer Housing	AISI 304	AISI 304	
32	Pump Housing Ring	AISI 304	AISI 304	

TPI is a family brand of NTN group.

Performance Curve

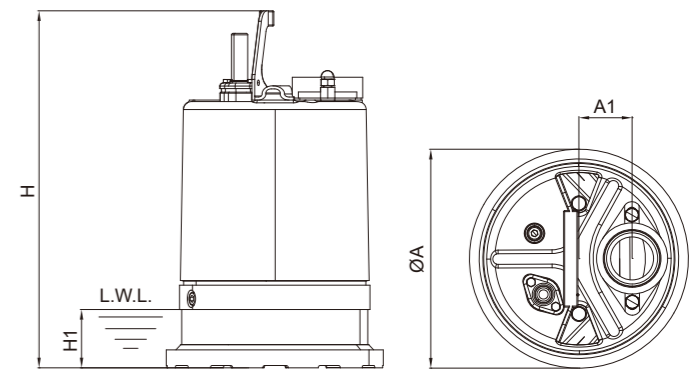
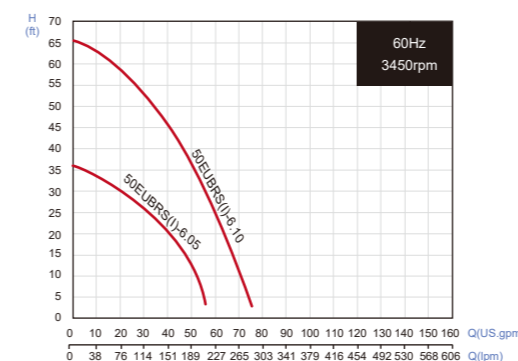
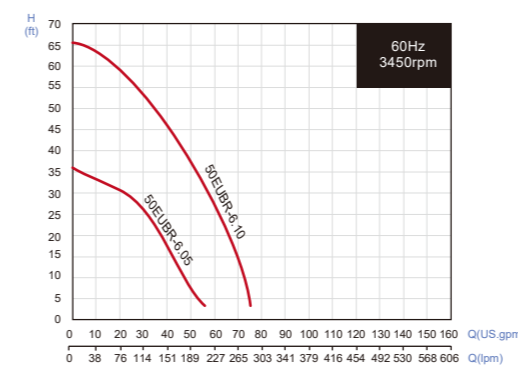

50EUBR-6.05-6.10

Dimensions (mm)

Type	A	A1	H	H1
	214	52	347	52
	184	52	345	52(50)
	214	52	372	52
	184	52	370	52(50)

All technical information is subject to change without notice.